

OPEN

MINUTE ITEM

ATTACHMENTS

**Ordinary meeting of the
Hearings Panel - Other**

**Wednesday 18 March 2020
Commencing at 9.00a.m.
Council Chamber**

Civic House

110 Trafalgar Street, Nelson

TABLE OF CONTENTS

PAGE

6	Findlay Place Easements - Deliberations Report	
A.	A2361218 - Findlay Place Service Diagram 2020	2
B.	A2282153 - Findlay Place Proposed Easement Site Diagram	3
C.	A2288406 - Findlay Place Indicative Area of ROW tabled document	4

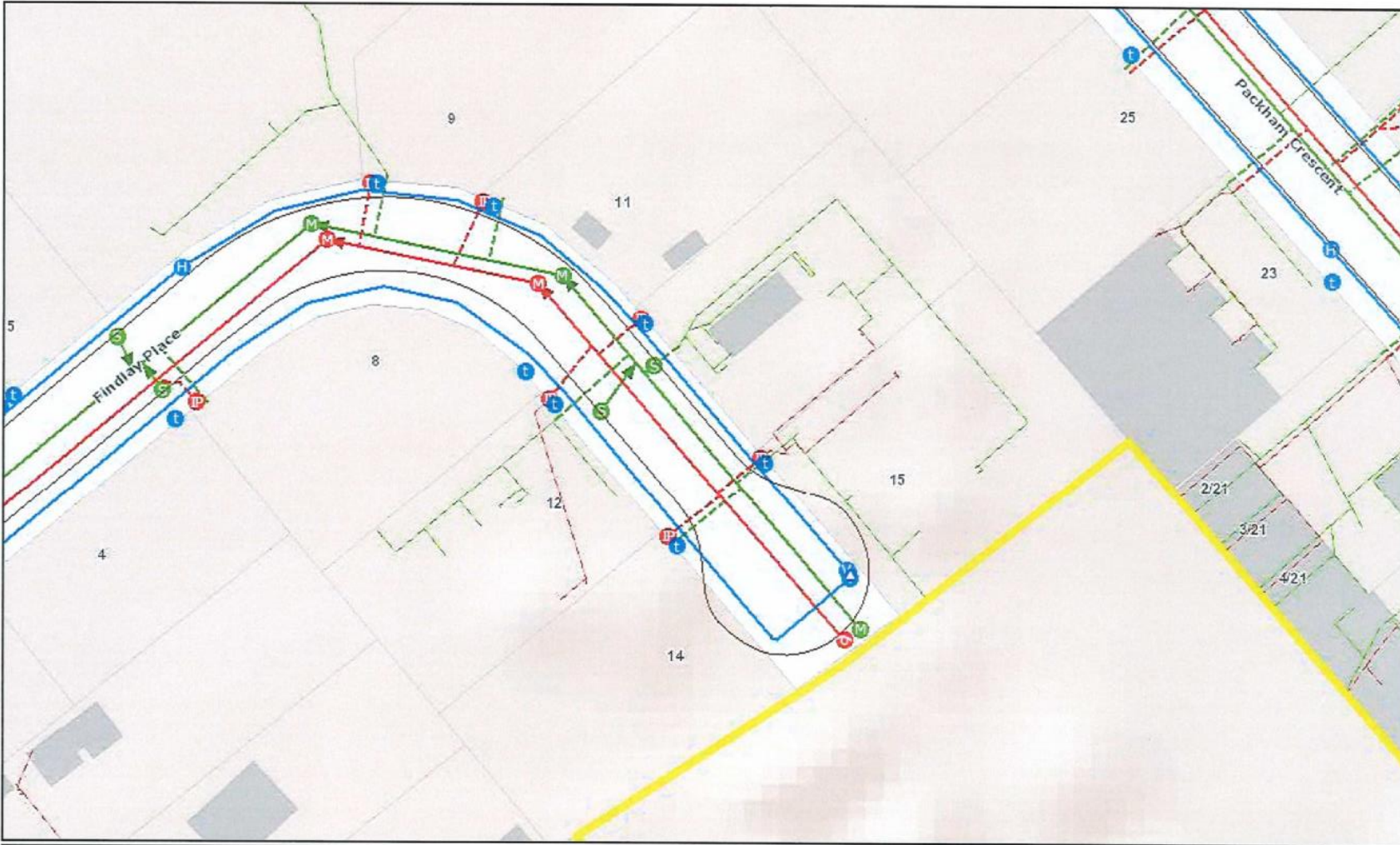

The map is an approximate representation only and must not be used to determine the location or size of items shown, or to identify legal boundaries. To the extent permitted by law Nelson City Council, their employees, agents and contractors will not be liable for any costs, damages or loss suffered as a result of the data or plan, and no warranty of any kind is given as to the accuracy or completeness of the information represented. Nelson City Council information is licensed under a Creative Commons Attribution-NonCommercial 3.0 licence. For more information please contact us. For more information please contact us. Caustical information derived from the Land Information New Zealand. CROWN COPYRIGHT RESERVED.

Findlay Place services



PO Box 645 Nelson 7040 New Zealand
 PH 03 5460200
 www.nelson.govt.nz

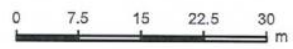

Scale 1:750



Date: 18/03/2020

A2361218

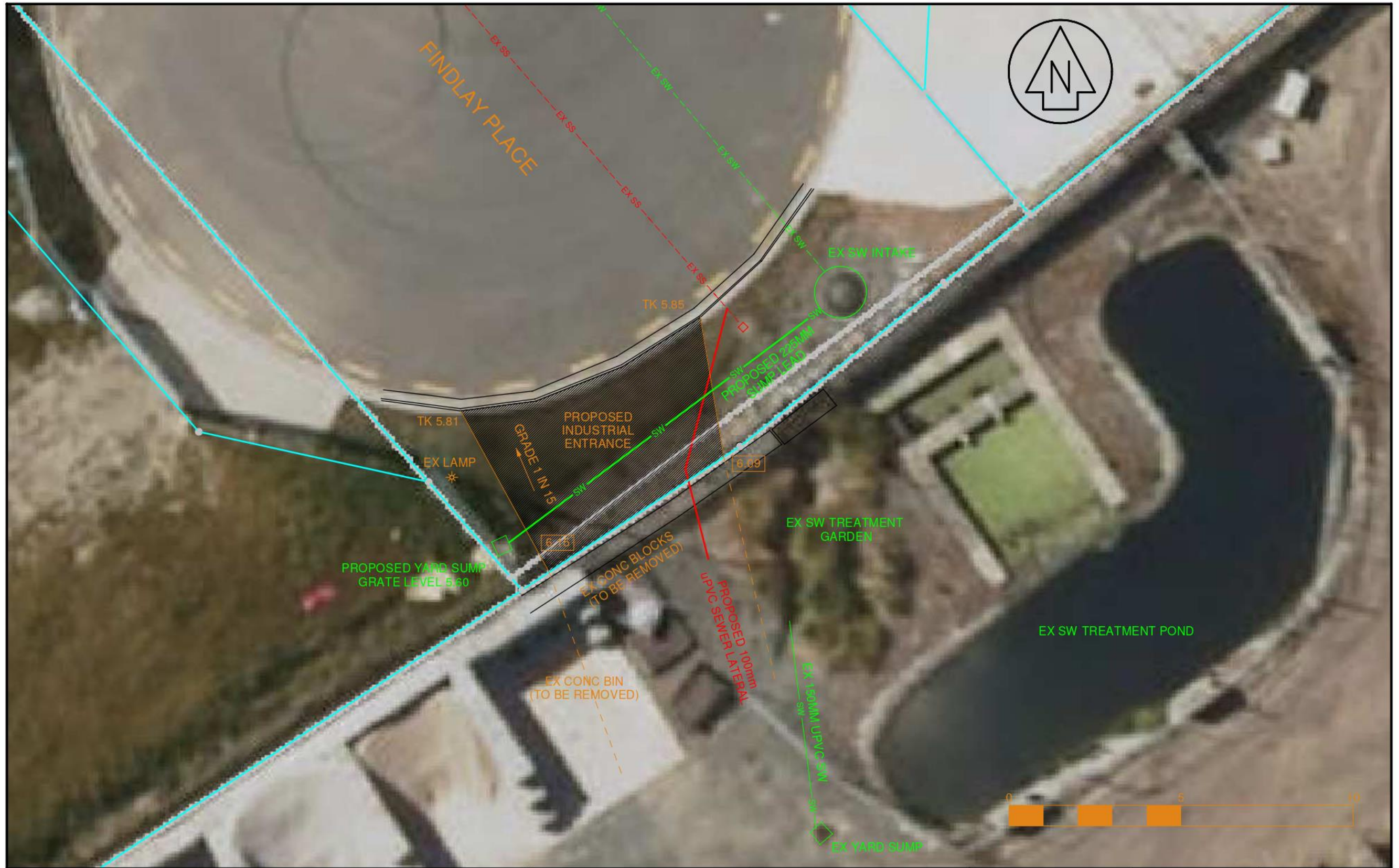

<p>Davis Ogilvie & Partners Limited 1st Floor, 277 Hardy Street, Nelson 7010 Office 0800 999 333 Email nelson@do.co.nz www.do.co.nz</p>	<h3>51 SAXTON ROAD WEST</h3> <h4>PROPOSED ENTRANCE OFF FINDLAY PLACE</h4>		Prepared for: AZWOOD	Designed by: TL Drawn by: TL	Scale @ A3: 1:100
	CAD File: T:\Projects\20000+35345 Wholesale Landscapes\CAD\35345 topo 190917 corrected.mjo - B		Comprised in: CT 271556	Revision: B Date: 18/09/19	Sheet Number: 1 OF 1 Project Number: 35345
			A2282153		



Aerial flown (resolution): Urban 20 Nov 17 (0.075m); Rural 24 Feb 14 (0.4m).

The map is an approximate representation only and must not be used to determine the location or size of items shown, or to identify legal boundaries. To the extent permitted by law Nelson City Council, their employees, agents and contractors will not be liable for any costs, damages or loss suffered as a result of the data or plan, and no warranty of any kind is made or intended. Nelson City Council information is licensed under a Creative Commons Attribution-NonCommercial 3.0 New Zealand License. Nelson City Council data must not be sold without prior written consent. For more information please contact us. Cadastral information derived from the Land Information New Zealand. CROWN COPYRIGHT RESERVED.

Findlay Place Indicative Area of ROW



PO Box 645 Nelson 7040 New Zealand
PH 03 5460200
www.nelson.govt.nz



Scale 1:250



Date: 15/10/2019

A2288406